

# How to Hang Ornaments on a Rod without Bending the Rod

If you have a 10" rod, keep ornaments to either side or you can add another post in the center for extra safety.

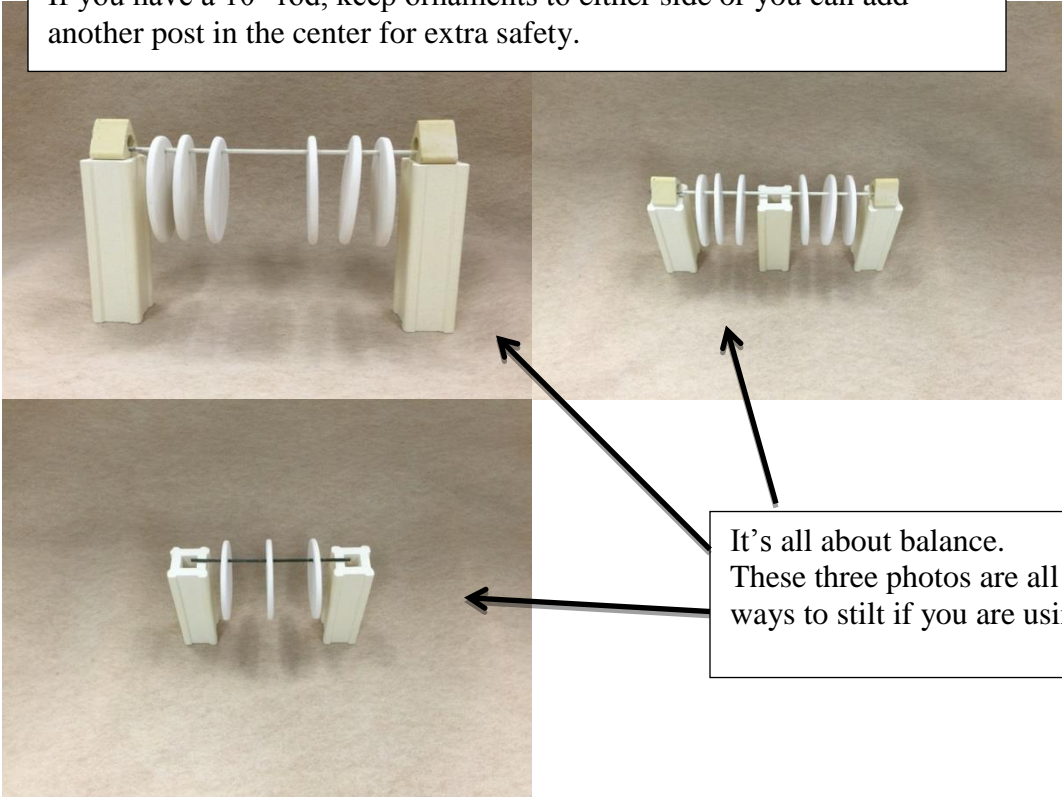

It's all about balance.  
These three photos are all correct ways to stilt if you are using rods.

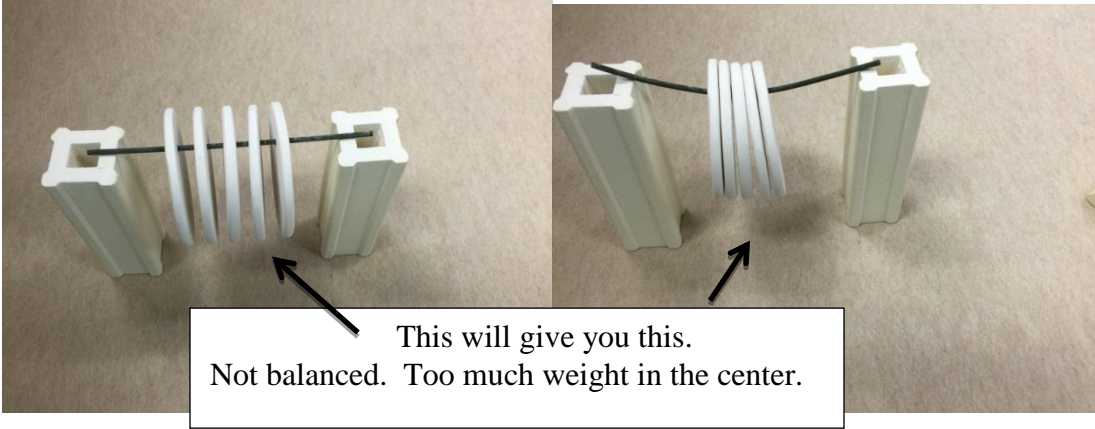

This will give you this.  
Not balanced. Too much weight in the center.

It's best to kiln wash the rods and also clean out the hole of the ornament after it's dipped in clear glaze to help keep the glaze from melting to the rod. If you take these precautions, you will reduce the chances of the rods bending.



phone 1.888.289.4273

fax 1.800.292.0885

www.gare.com