

How to Stilt Flat Ornaments

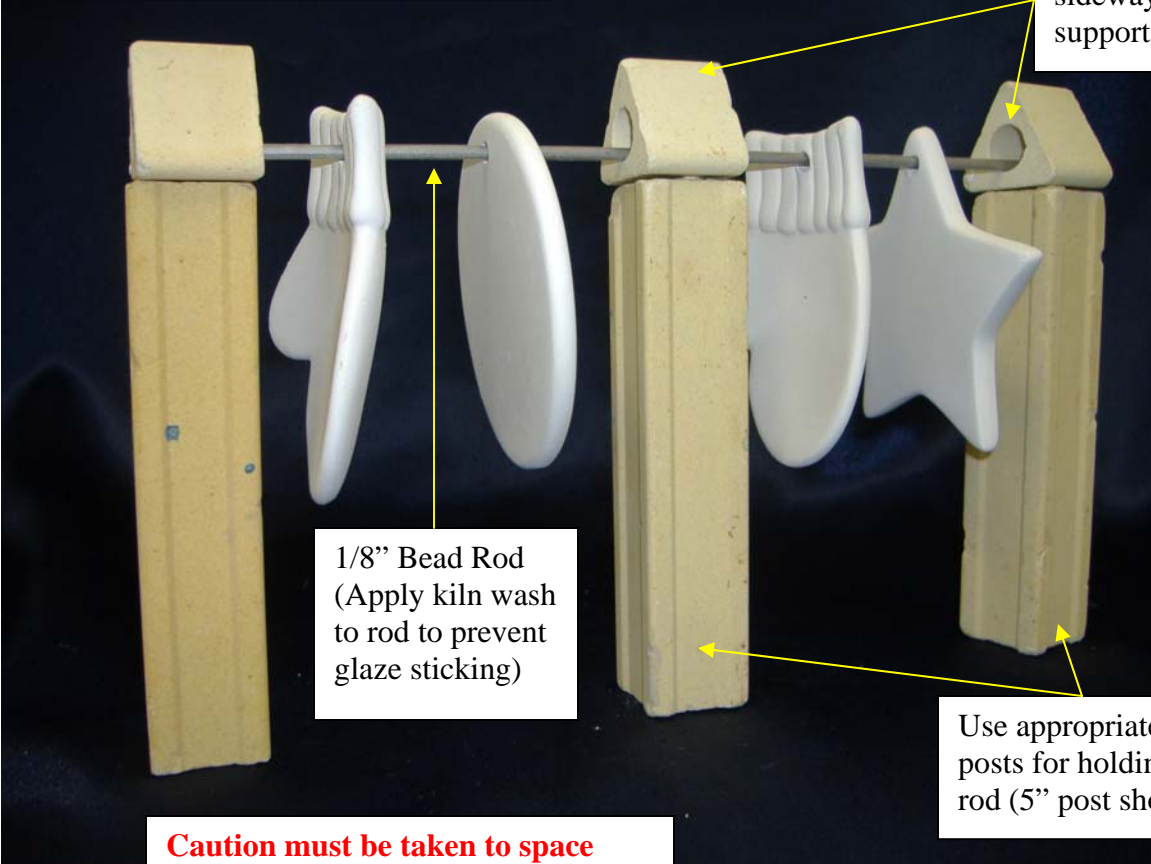

1" post set sideways to support bead rod.

1/8" Bead Rod
(Apply kiln wash to rod to prevent glaze sticking)

Use appropriate length posts for holding bead rod (5" post shown).

Caution must be taken to space ornaments so they won't touch. Rod must be supported sufficiently, or rod may bend.

gare[®]

phone 1.888.289.4273 x.17 fax 1.800.292.0885 email:srogers@gare.com www.gare.com